

RSE

RSEO

Einbausteckverbinder, M12-Stecker für Sensoren, mit kurzen Anschlusskontakten
RSEO: Pin 5 nicht voreilend

Receptacle connector, M12 male connector for sensors, with short solder contacts
RSEO: Pin 5 not leading

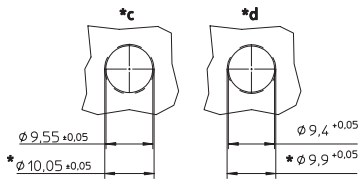
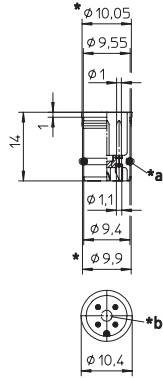

RSEL

Einbausteckverbinder, M12-Stecker für Sensoren, Anschlusskontakte für die Leiterplattenmontage

Receptacle connector, M12 male connector for sensors, solder contacts for printed circuit board mounting

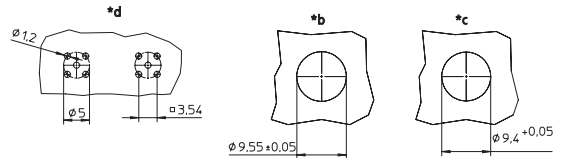
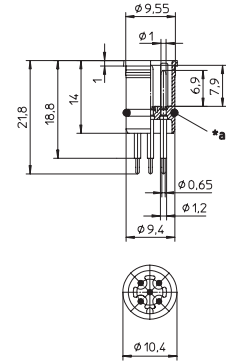

8-polig / 8 poles

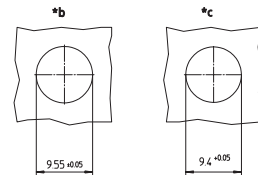
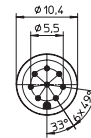
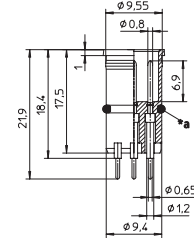

- *a O-Ring lose beige stellt
O-ring enclosed separately
- *b Entlüftungsbohrung
ventilation hole
- *c Einbauöffnung mit O-Ring
cut out with O-ring
- *d Einbauöffnung ohne O-Ring
cut out without O-ring

Pinbelegung Pin assignment

4-polig 4 poles



5-polig 5 poles



8-polig 8 poles











Kontakt 5 voreilend /
Contact 5 leading

- *a O-Ring lose beige stellt
O-ring enclosed separately
- *b Einbauöffnung mit O-Ring
cut out with O-ring
- *c Einbauöffnung ohne O-Ring
cut out without O-ring
- *d Lochbild in der Leiterplatte
hole pattern in printed circuit board

Technische Daten	
Umgebungstemperatur	-25°C / +80°C
Werkstoffe	
Kontaktträger	PA
Kontakt	CuZn, unternickelt und 0,8 µm vergoldet
O-Ring	FKM
Mechanische Daten	
Anschlussart	RSE: Lötanschluss RSEL: Printlötung
Anschließbarer Leiter	RSE: Massiv max. 0,75 mm ² Litze max. 0,50 mm ²
Elektrische Daten	
Durchgangswiderstand	≤ 5 mΩ
Nennstrom bei 40°C	4- bis 5-polig 4 A 8-polig 2 A
Nennspannung	4-polig 240 V 5-polig 60 V 8-polig 30 V bei gekapseltem Einbau
Bemessungsspannung	4-polig 250 V 5-polig 63 V 8-polig 36 V
Prüfspannung	4-polig 2,0 kV eff. / 60 s 5- bis 8-polig 1,5 kV eff. / 60 s
Isolationswiderstand	> 10 ⁹ Ω
Verschmutzungsgrad	3

Technical data	
Operating temperature range	-25°C / +80°C
Materials	
Insert	PA
Contact	CuZn, pre-nickel and 0.8 microns gold-plated
O-ring	FKM
Mechanical data	
Mode of connection	RSE: solder connection RSEL: printed circuit board mount
Connectable conductor	RSE: solid max. 0.75 mm ² stranded wire max. 0.50 mm ²
Electrical data	
Contact resistance	≤ 5 mΩ
Nominal current at 40°C	4–5 poles 4 A 8 poles 2 A
Nominal voltage	4 poles 240 V 5 poles 60 V 8 poles 30 V encapsulated
Rated voltage	4 poles 250 V 5 poles 63 V 8 poles 36 V
Test voltage	4 poles 2.0 kV eff. / 60 s 5–8 poles 1.5 kV eff. / 60 s
Insulation resistance	> 10 ⁹ Ω
Pollution degree	3

Bestellbezeichnung Designation		Polzahl Poles	Entlüftungsbohrung Ø Ventilation hole Ø
RSE 4	 	RSEL 4	
RSE 4 L			
RSE 5	 	RSEL 5	
RSE 5			
		RSEL 8	