



## DC



### Mountings columns for safety light curtains and multiple light beam safety devices

The DC mounting columns are used in order to mount Leuze lumiflex multiple light beam safety devices and safety light curtains. They permit an exact vertical and axial alignment, and protect the sensors from accidental damage.

The DC-1000 can handle 2-beam COMPACT, COMPACT*plus* or ROBUST multiple light beam safety devices or safety light curtains up to 900 mm protected heights.

The DC-1300 is designed for 3-beam or 4-beam multiple light beam safety devices or safety light curtains up to 1200 mm protected heights.

#### Accessories

The MS-DC/MC installation kit is optionally available for floor fastening.

Including spring elements made of synthetic material. It allows vertical and axial alignment.

### Special features

- Easy to mount, vertical and axial adjustment with MS-DC/MC installation kit (optional)
- Robust profiled construction in an attractive design

### Areas of use

Freestanding floor mounting of multiple light beam safety devices and safety light curtains.

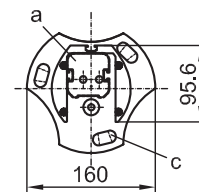
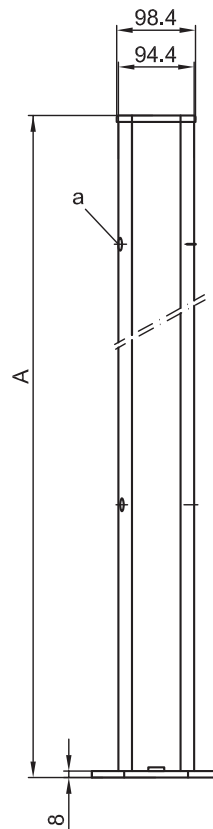

- a = COMPACT safety light curtain (example)
- b =  $\varnothing$  16 mm or  $\varnothing$  22 mm (number of boreholes depending on height of pillar)
- c = 3 drillings in the floor for plugs (diameter 10 mm)

#### Dimensional table

Type	Meas. A [mm]
DC-1000	1000
DC-1300	1300
DC-1600	1600
DC-1900	1900





## Ordering Information

### Order Numbers

Type	Order No.
DC-1000 *)	549410
DC-1300 *)	549413
DC-1600 *)	549416
DC-1900 *)	549419

\*) For the assembly of ECO, the ECO protection and assembly profile (order no.: see Accessories) is required.

## Accessories

### Order Numbers

Type	Order No.
Protection and assembly profile ECO-150	349801
Protection and assembly profile ECO-225	349802
Protection and assembly profile ECO-300	349803
Protection and assembly profile ECO-450	349804
Protection and assembly profile ECO-600	349806
Protection and assembly profile ECO-750	349807
Protection and assembly profile ECO-900	349809
Protection and assembly profile ECO-1050	349810
Protection and assembly profile ECO-1200	349812
LA 78C/R-UDC, Laser adjustable aid for COMPACT and ROBUST in the column UDC	560030
Top cover plate open (for cable exit at the top or for devices with extra length)	346172