



## GS 10

## Forked photoelectric sensors



2mm

10 - 30 V  
DC

- Fast amplifier with high switching frequency for detection of short events (e.g. gaps between labels)
- Universal application due to short circuit and polarity reversal protected PNP or NPN switching output
- Robust aluminium housing with bevelled inlet edges
- Indicator diode with large viewing area displays the switching state
- Easy calibration with calibration button for optimum sensitivity adjustment

### Dimensioned drawing

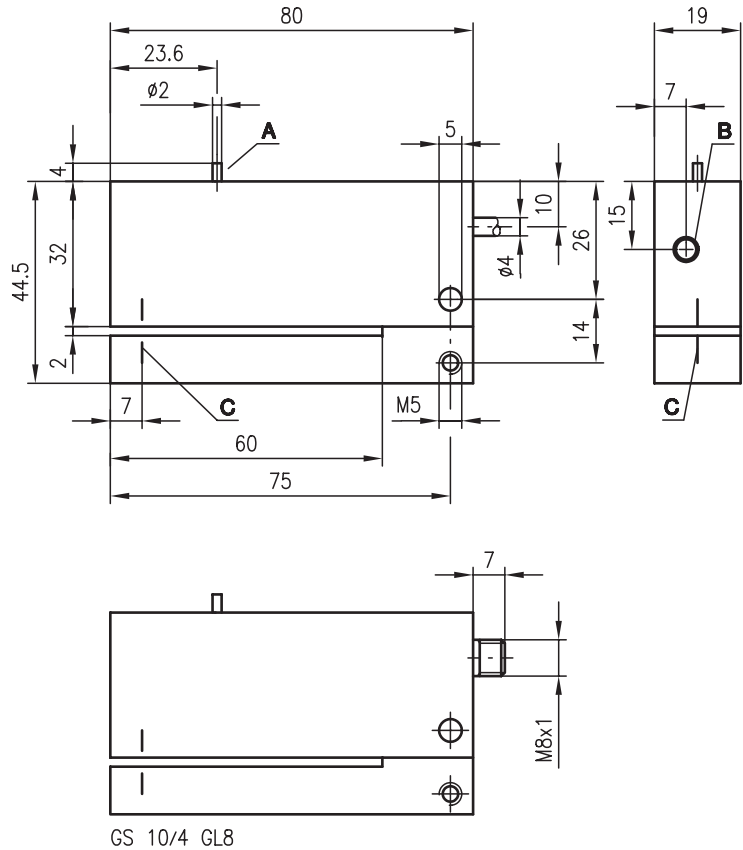

- A** Calibration button
- B** Indicator diode
- C** Optical axis

### Electrical connection

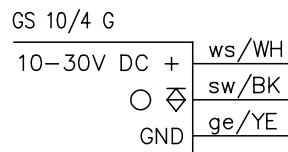
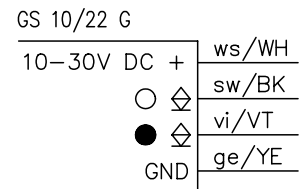
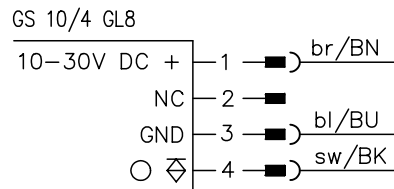

We reserve the right to make changes • GS\_a11e.fm



### Accessories:

(available separately)

- Ready-made cables (KB ...)
- M8 connectors (KD ...)



### Specifications

<b>Optical data</b>	
Mouth width	2mm
<b>Timing</b>	
Switching frequency	1000Hz
Response time	0.5ms
<b>Electrical data</b>	
Operating voltage $U_B$ <sup>1)</sup>	10 ... 30VDC (incl. residual ripple)
Residual ripple	≤ 15% of $U_B$
Bias current	≤ 50mA
Switching output	1 PNP transistor output, light switching or 2 NPN transistor outputs, light/dark switching
Signal voltage high/low	≥ ( $U_B - 2V$ ) ≤ 2V
Output current	100mA
Sensitivity	adjustable by pressing the calibration button
<b>Indicators</b>	
LED red	light path free
<b>Mechanical data</b>	
Housing	aluminium, anodised
Weight	120g connector version 170g cable version
Connection type	cable 2000mm (cross section 4x0.25mm <sup>2</sup> ) cable 2000mm (cross section 3x0.25mm <sup>2</sup> ) or M8 connector, 3-pin
<b>Environmental data</b>	
Ambient temp. (operation/storage)	-20°C ... +60°C / -30°C ... +70°C
Protective circuit <sup>2)</sup>	1, 2
VDE safety class	III
Protection class	IP 40

1) Functional extra-low voltage with reliable disconnection or protective extra-low voltage (VDE 0100/T 410)  
 2) 1=polarity reversal protection, 2=short-circuit protection for all outputs

### Tables

### Diagrams

### Order guide

Selection table		Order code →					
Equipment ↓		GS 10/22 G Part No. 500 17880	GS 10/4 G Part No. 500 13637	GS 10/4 GL8 Part No. 500 21319			
Switching output	1 PNP		●	●			
	2 NPN	●					
Connection	M8 connector			●			
	3-wire cable		●				
	4-wire cable	●					
Switching	light switching		●	●			
	light/dark switching	●					

### Remarks

- The sensitivity of the device is set by placing the material with the attached labels in the light beam and pressing the calibration button.
- Setup by untrained personnel possible when changing labels.
- The set value of the sensitivity is retained when the operating voltage is switched off.