



PRK 8

Retro-reflective photoelectric sensors



Dimensioned drawing

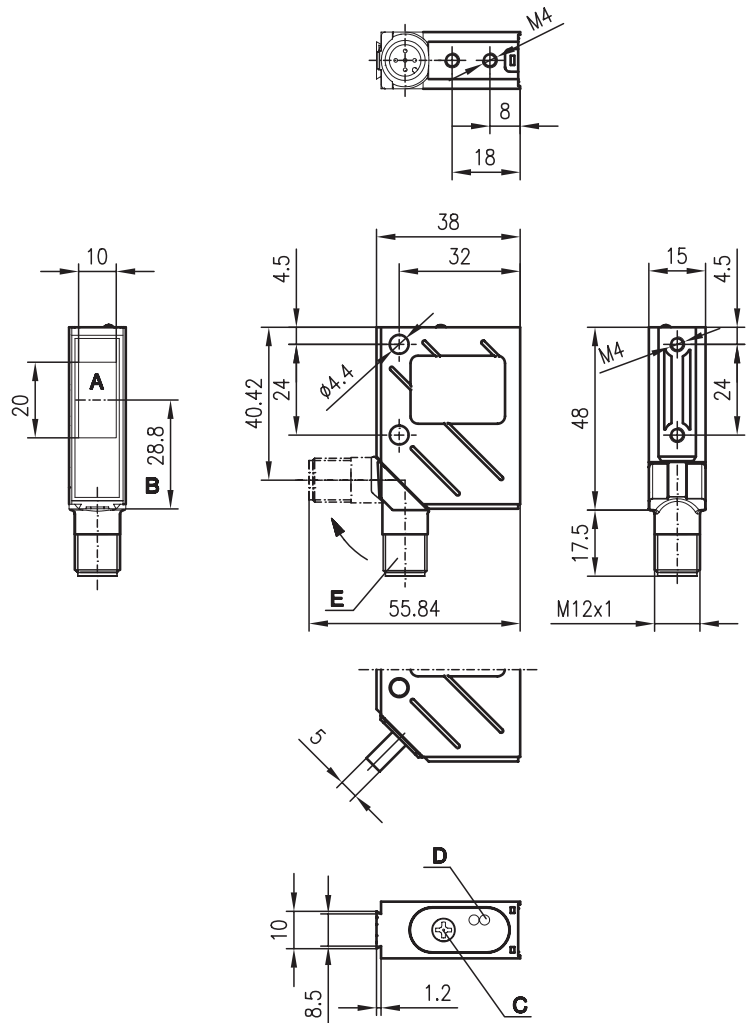

- A Transmitter/receiver
- B Optical axis
- C Operational control
- D LED yellow
- E 90° turning connector

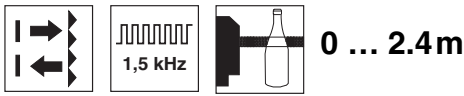

- Detection of transparent media (e. g. clear glass, PE, foil)
- The autocollimation principle used ensures that the device functions reliably over the entire range (0 ... max.)
- Push-pull switching outputs
- M12 turning connector
- Visible red light
- Square light spot

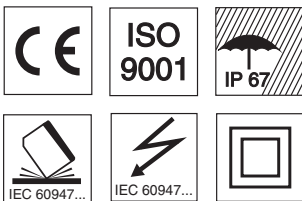

Accessories:

(available separately • see page 72)

- M12 connectors (KD ...)
- Cable (KB ...)
- Mounting systems
- Reflectors
- Reflective tapes
- Control guard

Electrical connection

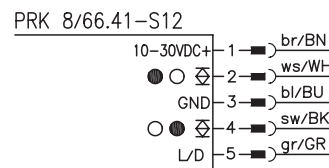

We reserve the right to make changes • 8\_b03e.fm



## Specifications

### Optical data

Typ. operating range limit (TK(S) 100x100) <sup>1)</sup>	0 ... 2.4m
Operating range <sup>2)</sup>	see tables
Recommended reflector	MTK(S) 50x50
Light source	LED (modulated light)
Wavelength	660nm (visible red light)
Light spot	square, focussed at 200mm

### Timing

Switching frequency	1500Hz
Response time	0.33ms
Delay before start-up	≤ 650ms

### Electrical data

Operating voltage $U_B$	10 ... 30VDC
Residual ripple	≤ 15% of $U_B$
Bias current	≤ 35mA
Switching output/function	2 push-pull switching outputs <sup>3)</sup> pin 2: PNP dark switching, NPN light switching pin 4: PNP light switching, NPN dark switching
Signal voltage high/low	≥ ( $U_B - 2V$ ) / ≤ 2V
Output current	max. 100mA
Sensitivity	adjustable with 12-turn potentiometer

### Indicators

LED yellow	light path free operating point of tape, PE – transition from flashing to continuous light light path free, no performance reserve
LED yellow flashing	

### Mechanical data

Housing	metal
Optics cover	glass
Weight	70g
Connection type	M12 connector, 5-pin (turning)

### Environmental data

Ambient temp. (operation/storage)	-40°C ... +60°C / -40°C ... +70°C
Protective circuit <sup>4)</sup>	2, 3
VDE safety class <sup>5)</sup>	II, all-insulated
Protection class <sup>6)</sup>	IP 67
LED class	1 (acc. to EN 60825-1:1994 +A1:2002 +A2:2001)
Standards applied	IEC 60947-5-2

### Options

<b>L/D input</b>	
Dark switching/light switching	$U_B/0V$ or not connected
L/D delay	< 0.5ms

- 1) Typ. operating range limit: max. attainable range without performance reserve
- 2) Operating range: recommended range with performance reserve
- 3) The push-pull switching outputs must not be connected in parallel
- 4) 2=polarity reversal protection, 3=short-circuit protection for all outputs
- 5) Rating voltage 250VAC
- 6) In stop position of the turning connector (turning connector locked)

## Order guide

	Designation	Part No.
with M12 connector	PRK 8/66.41-S12	500 37134

## Tables

Reflectors			Operating range
1	TK(S)	100x100	0 ... 2.0m
2	MTK(S)	50x50	0 ... 1.5m
3	TK(S)	30x50	0 ... 0.6m
4	TK(S)	20x40	0 ... 0.6m
5	Tape 2	100x100	0 ... 0.3m

1	0		2.0	2.4
2	0		1.5	1.8
3	0	0.6	0.8	
4	0	0.6	0.8	
5	0	0.3	0.5	

Operating range [m] \*

Typ. operating range limit [m] \*

\*) For sensitivity set to operating point 3

TK ... = adhesive  
TKS ... = screw type  
Tape 2 = adhesive

## Diagrams

## Remarks

- preferably use MTK(S) 50x50.
- note the light spot geometry and installation conditions