

Data Sheet

base modules: connectors



Total Access & Control

eGard offers "Total access & control". The innovative modular design allows configurations of purely safety gate switches, purely trapped key interlocks, purely machine control stations or any combinations of all three.

description:

a selection of four base modules including a foot module to terminate purely mechanical configurations and three types of electrical connection module all incorporating quick disconnects.



connector options:

safety only connector

basic connection module for connecting safety circuits only. Cannot connect I/O "input/output". i.e. lamps, pushbuttons).

BS



safety & control connector

connects safety circuits and control circuits (I/O "input/output", i.e. lamps, pushbuttons).

BC (8 I/O)
BB (2 I/O)



as-i safety & control connector

Standard 4 pin connector to suit AS-interface connectors

BA (4 I & 4 O)



foot

For terminating purely mechanical configurations

BF



part number

part number

www.fortressinterlocks.com

= This is a **Control** Module

= This is a **Safety** Module

Data Sheet

base modules: connectors



technical specification

Safety Only Connector

Housing Material	PBT
Colour	Light Grey & Dark Grey
Ingress Protection	IP65
Ambient Temperature	-5°C to + 40 °C
Connection Type	4 - pin Micro Change M12
Current	150mA
Voltage	24V DC

Safety & Control Connector

Housing Material	PBT
Colour	Light Grey & Dark Grey
Ingress Protection	IP65
Electrical Life	1000000 Operations
Ambient Temperature	-5°C to + 40 °C
Connection Type	14 - pin Mini Change
Current	150mA
Voltage	24V DC

ASi Control & Safety Connector

Housing Material	PBT
Colour	Light Grey & Dark Grey
Ingress Protection	IP65
Electrical Life	1000000 Operations
Ambient Temperature	-5°C to + 40 °C
Connection Type	4 - pin Micro Change M12
Current	150mA
Voltage	24V DC

Foot

Housing Material	PBT
Colour	Light Grey & Dark Grey
Ingress Protection	IP65
Ambient Temperature	-5°C to + 40 °C

Head Cap & Actuator Input Outputs

Part Number	Module	Input (1)	Output (0)	Order of pin assignment from base to head	Module operates on safety circuits
BS	Safety Only	0	0	-	✓
BB	Safety & Control 2 I/O	Max 2 I/O		-	✓
BC	Safety & Control 8 I/O	Safety & Control 8 I/O		-	✓
BA	Safety & Control Asi	4 I & 4 O		-	✓

*For further information on eGard configuration rules please [click here](#)

Technical Data base modules: connectors



BS Drawing

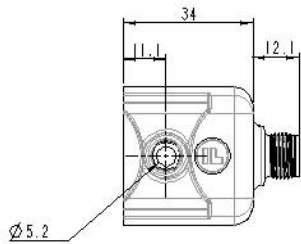

DETAIL A
SCALE 5.000

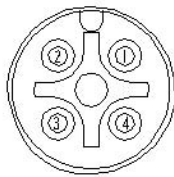

PIN	DESCRIPTION
1	SAFETY CIRCUIT 1
2	SAFETY CIRCUIT 2
3	SAFETY CIRCUIT 1
4	SAFETY CIRCUIT 2

M12 x 1mm PITCH THREAD

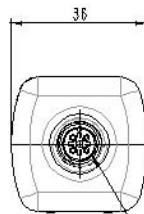
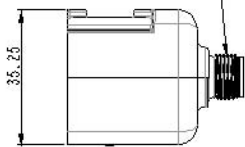

SEE DETAIL A

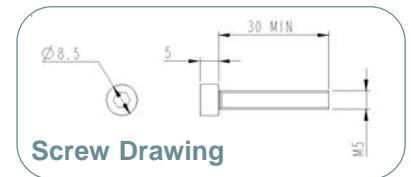

Screw Drawing

BB/BC Drawing

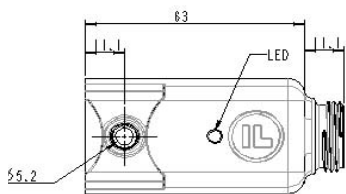

DETAIL A
SCALE 5.000

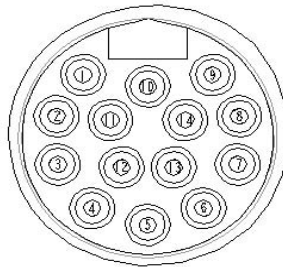

PIN	BC DESCRIPTION	BB DESCRIPTION
1	1/O 3	N/A
2	1/O 2	N/A
3	1/O 1	1/O 1
4	+24V	+24V
5	SAFETY CIRCUIT 2	SAFETY CIRCUIT 2
6	0V	0V
7	1/O 6	N/A
8	1/O 5	N/A
9	1/O 4	N/A
10	SAFETY CIRCUIT 1	SAFETY CIRCUIT 1
11	1/O D	1/O 0
12	SAFETY CIRCUIT 2	SAFETY CIRCUIT 2
13	SAFETY CIRCUIT 1	SAFETY CIRCUIT 1
14	1/O 7	N/A

LED STATUS	MEANING
OFF	POWER FAILURE / FAULT
FLASHING AT 0.5 Hz	WORKING CORRECTLY
ON CONTINUOUSLY	FAULT

7/8" x 16 TPI THREAD

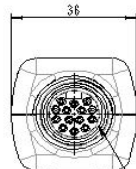
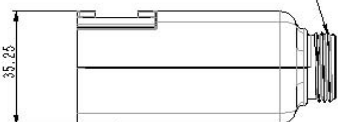

SEE DETAIL A

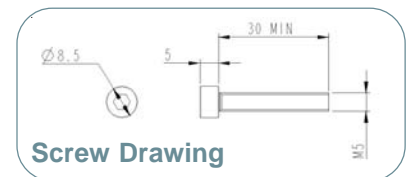

Screw Drawing

Technical Data base modules: connectors



BA Drawing

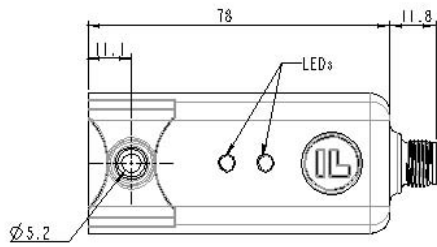

DETAIL A
SCALE 5.000

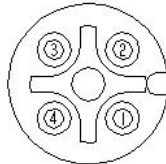

PIN	DESCRIPTION
1	ASi +
2	
3	ASi -
4	

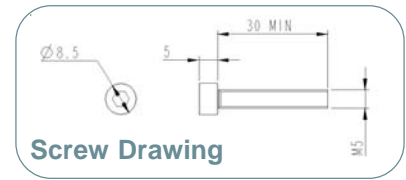
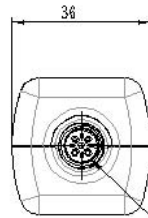
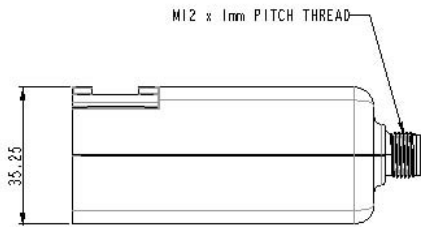

Screw Drawing

BF Drawing

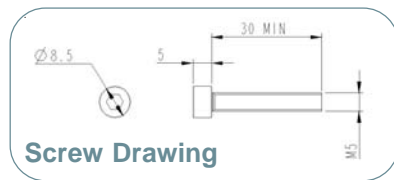
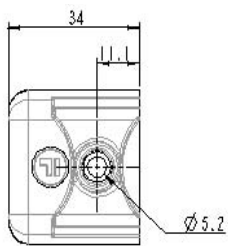

Screw Drawing

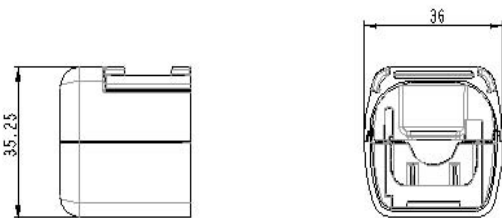

www.fortressinterlocks.com