

CL Basic and Key Breaker Lock Installation Instructions

Merlin Gerin



An adaptor kit is required from the breaker manufacturer in order to fit this product.

Please note the ABB Breaker lock (CLIN-AC090AB) is designed to fit all Sace breakers.

The Merlin Gerin Breaker lock (CLIN-MC090MG) is designed to fit all Merlin Gerin breakers.

Protection Against Environmental Influences

A lasting and correct safety function requires that the unit be protected against the ingress of foreign bodies such as swarf, sand, blasting shot etc.

The unit is to be mounted away from the machine, or by using anti-vibration mountings, in order to avoid the effects of vibration, shock and bump.

Functionality

The key is inserted and turned, turning the spindle projecting from the basic lock. (With mounting bracketry the spindle can operate switchgear etc.)

The key is freed in the 12 o'clock position. Standard movement is 90 degrees clockwise.

Service and Inspection

There are no user serviceable parts in this unit. If damage or wear is found the whole unit must be replaced. If lubrication is required use WD40. Do not use dry lubricant.

Regular weekly inspection of the following is necessary to ensure trouble-free, lasting operation:-

- Correct operation
- Secure mounting of components
- Debris and wear

The complete lock must be replaced after 1 million operations.

ABB



Description

A robust disc tumbler lock offering 201,810 non-masterable combinations. A spring loaded dustcover is available as an optional extra.

IMPORTANT

This product is designed for use according to the installation and operating instructions enclosed.

It must be installed by competent and qualified personnel who have read and understood the whole of this document prior to commencing installation. Any modification to or deviation from these instructions invalidates all warranties.

Fortress Interlocks Ltd accepts no liability for any situation arising from misuse or mis-application of this product.

IF YOU HAVE ANY QUESTIONS OR QUERIES OF ANY NATURE

PLEASE CONTACT YOUR SUPPLIER WHO WILL BE PLEASED TO ADVISE AND ASSIST.

Please refer to Merlin Gerin/ABB installation instructions as appropriate in order to fit this lock.

Disposal

This lock does not contain any certified hazardous materials so should be disposed of as industrial waste.

Liability coverage is voided under the following conditions:

- 1 If these instructions are not followed
- 2 Non-compliance with safety regulations
- 3 Installation not performed by authorised personnel
- 4 Non-implementation of functional checks.

Environmental Specification

Environment Type Indoor
Max. Altitude 2000m
Ambient Temperature -40°C + 150°C

Ingress Protection IP50
With Dustcover fitted.

Vibration Tested in accordance with BS EN 60068-2-64:1995

Frequency Range 20-2000Hz
Severity 5.0(m/s²)/Hz
No of Axes 3 (Longitudinal, Lateral & Vertical)

The manufacturer reserves the right to modify the design at any time and without notice. This guide should be retained for future reference.

Standard Lock

FORTRESS CL LOCK FITTED WITH MERLIN GERIN MASTERPACT REAR CASING ADAPTOR AND COUPLING PIECE

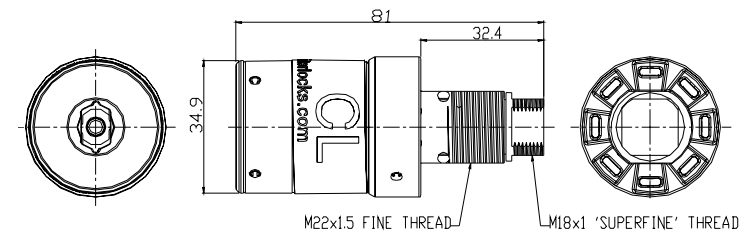

FORTRESS CL LOCK FITTED WITH ABB EMAX REAR CASING ADAPTOR

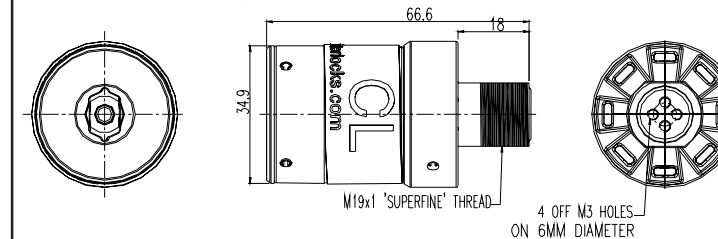

Featuring Optional Dustcover

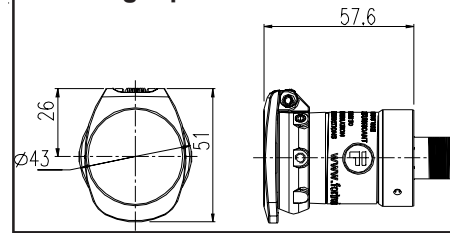

CL Standard Key

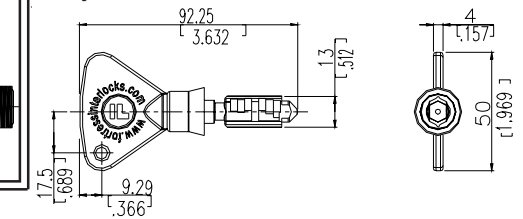

CL Low Profile Key

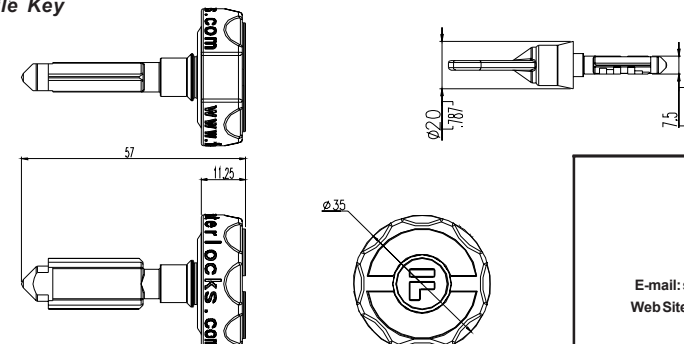

Fortress Interlocks Limited
148-150 Birmingham New Road
Wolverhampton, UK, WV4 6NT
Tel: +44 (0) 1902 499600
Fax: +44 (0) 1902 499610
E-mail: sales@fortress-interlocks.co.uk
Web Site: www.fortress-interlocks.co.uk