

For Gate Valves, Globe Valves, Gear Operated Valves and all other wheel operated valves.

Safety Note: Do not break the pressure envelope of the valve.

Locks are manufactured and sent in the locked open position, ensure the valve is in open position before installation.

Lubricate all moving parts of the GG interlocking unit with Nickel/Graphite Anti-Seize compound (Bostik Never-Seez recommended). The internals of the CLS locks should be lubricated with WD40.



Fig. 1. Ensure valve is in open position and L.O Key can be released before installation. Remove existing valve hand wheel and nut. Discard both.

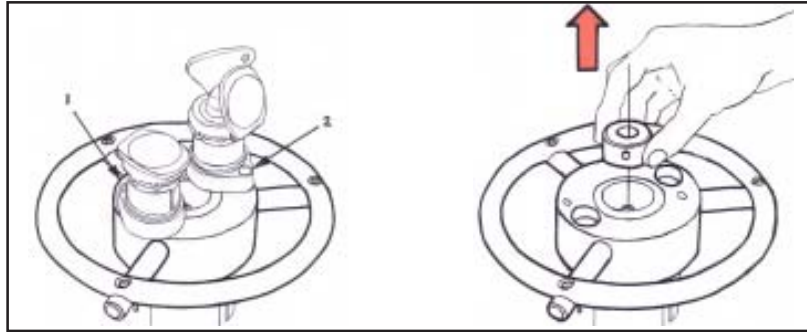

Fig. 2. Remove the security nut from the interlock. This may require the removal of the CLS locks depending on the interlocks size. The locks can be removed by removing screws marked 1 & 2. Immediately refit the locks as before.

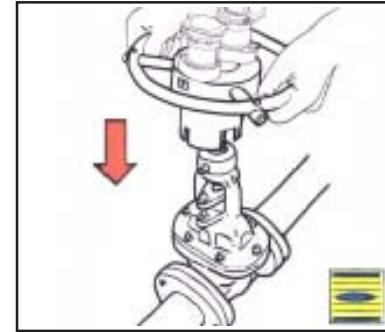

Fig. 3. Position interlock on valve, engaging cutouts with valve yoke.

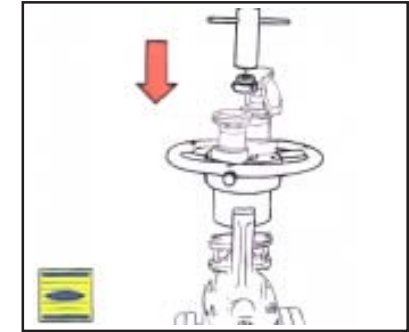

Fig. 4. Secure interlock in place with security nut and tool supplied (thread lock recommended). This may again require removal & refitting CLS locks.

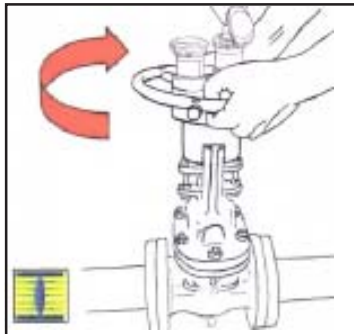

Fig. 5. Operate valve to closed position

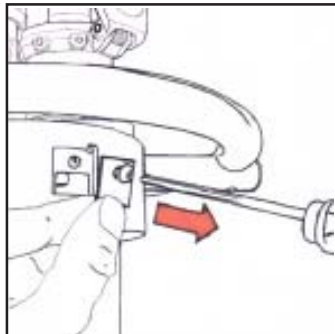

Fig. 6. If closed position key needs adjustment, "remove cover".

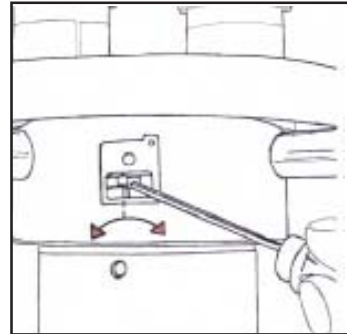

Fig. 7. Rotate gear to give correct key free position. Rotate till key is released. The valve lock is now ready installed.

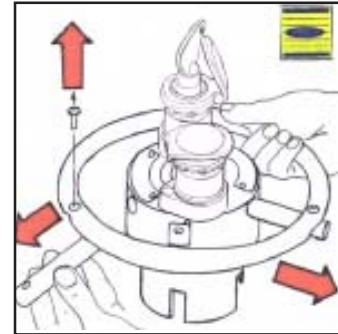

Fig. 8. If lock needs adjustment in the open position, remove handwheel spokes. Only required if open position is not adjusted per instruction Fig.1

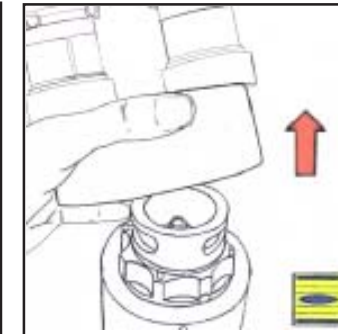

Fig. 9. Lift body off assembly

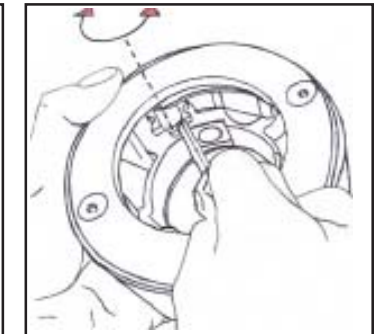

Fig. 10. Make necessary adjustments by rotating 'open' gear. To give correct setting. Refit interlock, and re-check for correct operation.